



CHALET CLOSE JOYDENS WOOD BEXLEY  
DA5 2EY  
Guide Price £600,000 | Freehold





Park Estates are delighted to offer this three bedroom extended detached house, situated in a very pleasant cul de sac, within close proximity of popular local shops, schools, Joydens Wood and transport links. Offering lots of potential, this chain free property does require updating and comprises of downstairs wc, two reception rooms, extended kitchen / breakfast room, easy access to the garage which could be integrated into the living space, three good size bedrooms and a shower room. Other features include a 55'1 approx garden, gas central heating and double glazing. Early viewing is highly recommended.

Local Authority: Dartford  
Council Tax Band: F

Energy Efficiency Rating			
Score	Energy rating	Current	Potential
92+	A		81  B
81-91	B		
69-80	C		
55-68	D		
39-54	E	53  E	
21-38	F		
1-20	G		



# 01322 553322

60-62 High Street, Bexley, Kent DA5 1AH

bexley@parkestates.co.uk  
www.parkestates.co.uk

## Chalet Close, DA5

Approximate Gross Internal Area = 106 sq m / 1146 sq ft  
Approximate Garage Internal Area = 14 sq m / 147 sq ft  
Approximate Total Internal Area = 120 sq m / 1293 sq ft

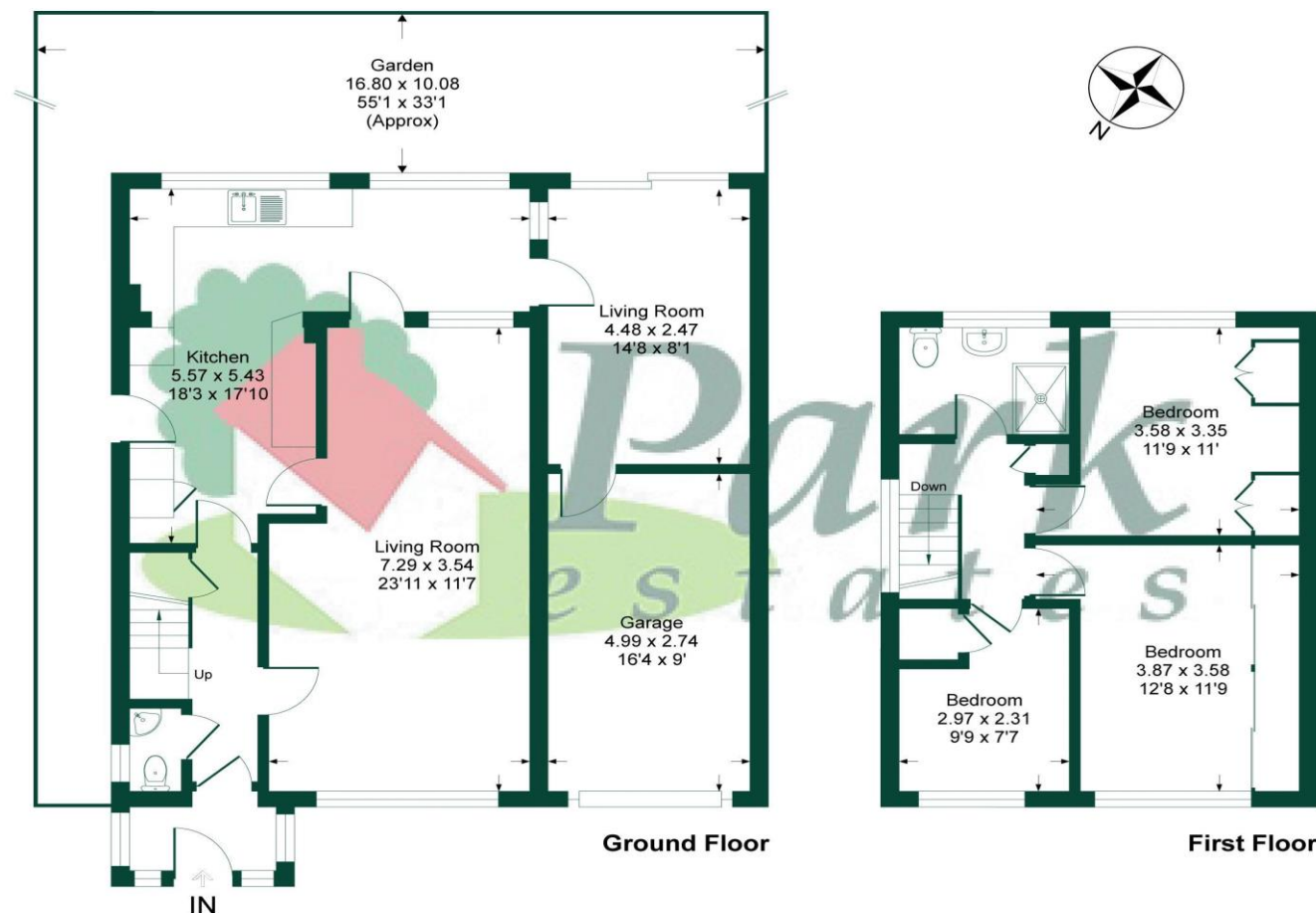

This plan is for layout guidance only. Not drawn to scale unless stated. Windows and door openings are approximate. Whilst every care is taken in the preparation of this plan, please check all dimensions, shapes and compass bearings before making any decisions reliant upon them.  
Produced by Planpix

Every care has been taken with the preparation of details, but accuracy is in no way guaranteed. These particulars do not constitute a contract and are issued and accepted on the express understanding that all negotiations will be conducted through Park Estates. The seller does not make or give, nor do we or our employees have any authority to give a representation or warranty in relation to the property. Please contact this office before viewing the property. If there is any point which is of particular importance to you, we will be pleased to check the information for you and confirm that the property remains available. This is particularly important if you are contemplating travelling some distance to view the property. We would strongly recommend that all the information that we provide about the property is verified by yourself on inspection and also by your conveyancer, especially where statements have been made by us to the effect that the information provided by us has not been verified.